



6320 Research Rd.  
Frisco, TX 75033

T 972.668.9340  
F 972.668.9351

# Proposal

**Date:** October 22, 2024  
**Owner:** City of Coppell  
**Project:** 24-04-029 – CoCoppell – Andy Brown Park West Basketball Courts  
**Location:** Coppell, Texas  
**Procurement:** TIPS 230104-02

CORE Construction is pleased to provide you with this proposal. Enclosed you will find the basis of estimate clarifications and schedule of values which includes the requested scope of work, general conditions, sales tax, bonds, insurances, and fee.

**Total Proposal - \$119,615.00**

We look forward to a successful and enjoyable project together. Thank you for this opportunity, please do not hesitate to contact me directly with any questions or comments.

Respectfully submitted,

*Alex Schies*

Alex Schies  
CORE Construction Services of Texas, Inc.

The Basis of Estimate is a written explanation clarifying the scope, assumptions and exclusions used in establishing this proposal. All costs are developed through site walk conducted, and the scope clarifications below.

## Assumptions, Clarifications, & Exclusions

---

### Schedule

- Anticipated Start: Upon Receipt of PO and materials are received
- Long Lead Items: 8 weeks for basketball hoops
- Projected Duration: 3 weeks

### Contingency & Allowances

- **Change Management** – Based on direction from the Owner, CORE has not included contingencies and/or allowances. Any unforeseen conditions, schedule impacts (outside of contractor control), scope changes, escalation, acceleration, overtime, premium time, etc. will result in Owner Change Orders. In addition, the time necessary to price and confirm formal authorization to proceed could have an impact on the overall construction schedule. Including contingencies and or allowances in the base contract allow the Project Team to avoid these items within the originally defined schedule and established contract amount.

### General Assumptions

- This cost proposal is considered a Lump Sum, not line-item Estimate.
- Unless otherwise included in scope below, CORE has not included any costs for permits, including but not limited to: building permit, systems permit, or dust control.
- General Conditions and/or General Requirements are considered cost of the work.
- A registered professional did not provide sealed plans or specifications and therefore no form of permit is in place. CORE Construction Services of Texas, Inc. shall not be held responsible for performance of systems or equipment, code interpretations, engineering, etc. requirements and will perform the requested scope of work as defined by the Owner representative(s).
- Proposal valid for 30 days, unless otherwise directed by CORE Construction.

### Specific Assumptions

#### DEMOLITION –

- **Demolition** – Includes the demolition and removal of (6) Wausau Tile Basketball Goals.

#### STRUCTURE –

- **Concrete** – Minor concrete patching as needed around the new basketball goals.

#### SPECIALTIES –



- **Concrete Scanning** – Subsurface utility investigation and 2D GPR scan of the surrounding areas to locate utilities, rebar, and irrigation system.

#### EQUIPMENT–

- **Basketball Goals** – Provide and install (6) Draper EZ-Fold 5065XY Gooseneck Outdoor Basketball System with new steel posts and a 6' overhang, to keep existing court markings.

#### MISCELLANEOUS–

- **Site Protection** – Provide and install necessary site protection for the demolition and installation of the basketball hoops. Installation of temporary chain link fencing around the basketball court for the duration of the project.

#### Specific Exclusions

- Costs associated with Material Testing and/or Special Inspections
- Costs associated with General Building Inspections
- FF & E – Furniture, Fixtures, and Equipment (by Owner)
- Structural modifications (i.e. - Steel, Concrete & Masonry removal or replacement)
- Resurfacing and striping of the courts
- Visual Display Boards





**Preliminary Estimate, by estimates**

Alex Schies

Core Construction

230104-02 - 2023 TIPS-Core Construction - Basic Contract Year - 4/27/2023 to 4/26/2024

CoCoppell - Andy Brown Park West Bball Courts - 24-04-029

**Estimator: Alex Schies**

**CoCoppell - Andy Browk Park West Bball Courts**

**Division Summary (MF04)**

01 - General Requirements	\$61,768.21
02 - Existing Conditions	\$4,810.00
03 - Concrete	\$3,850.00
04 - Masonry	
05 - Metals	
06 - Wood, Plastics, and Composites	
07 - Thermal and Moisture Protection	
08 - Openings	
09 - Finishes	
10 - Specialties	
11 - Equipment	
12 - Furnishings	
13 - Special Construction	
14 - Conveying Equipment	
21 - Fire Suppression	
22 - Plumbing	
23 - Heating, Ventilating, and Air-Conditioning (HVAC)	
25 - Integrated Automation	

26 - Electrical	
27 - Communications	
28 - Electronic Safety and Security	
31 - Earthwork	
32 - Exterior Improvements	
33 - Utilities	
34 - Transportation	
35 - Waterway and Marine Transportation	
41 - Material Processing and Handling Equipment	
44 - Pollution Control Equipment	
46 - Water and Wastewater Equipment	
48 - Electric Power Generation	
Item Specific Scope & Crews	\$71,383.09
Trades	
Assemblies	
FMR	
<b>MF04 Total (Without totalling components)</b>	<b>\$141,811.30</b>

**Totalling Components**

Priced Line Items	\$141,811.30
RSMean DALLAS, TX CCI 2024, 85.20%	\$(20,988.07)
2023 TIPS-Core Construction Standard (-1.0000%)	\$(1,208.23)

Nonpriced Line Items	
2023 TIPS-Core Construction Nonpriced (22.0000%)	

**Material, Labor, and Equipment Totals (No Totalling Components)**

Material:	\$45,696.00
Labor:	\$79,736.69
Equipment:	\$11,218.61
Other:	\$5,160.00
Laborhours:	411.69
Green Line Items:0	\$0.00

**Priced/Non-Priced**

Total Priced Items:	24	\$141,811.30	
Total Non-Priced Items:	0	\$0.00	0.00%
	24	\$141,811.30	

**Grand Total \$119,615.00**

# Preliminary Estimate, by estimates

**Estimator: Alex Schies**

**CoCoppell - Andy Browk Park West Bball Courts**

Item	Description	UM	Quantity	Unit Cost	Total	Book
<b>01 - General Requirements</b>						
1	01-21-53-50-0550-M Cost adjustment factors, cut & patch to match existing construction, add to construction costs for particular job requirements, maximum Patching of existing area for replacement of new basketball hoops	Costs	120,000.0000	5.0000%	\$6,000.00	RSM24MCOM M, O&P P
2	01-21-53-50-1150-M Cost adjustment factors, equipment usage curtailment, add to construction costs for particular job requirements, maximum	Costs	120,000.0000	3.0000%	\$3,600.00	RSM24MCOM M, O&P P
3	01-21-53-50-1750-L Cost adjustment factors, protection of existing work, add to construction costs for particular job requirements, maximum Protective material to protect the court and sidewalk between the parking lot and on the courts	Costs	120,000.0000	7.0000%	\$8,400.00	RSM24MCOM L, O&P P
4	01-31-13-20-0220 Field personnel, project manager, maximum 3 weeks of Project Manager	Week	3.0000	\$4,274.00	\$12,822.00	RSM24MCOM L, O&P P
5	01-31-13-20-0280 Field personnel, superintendent, maximum 3 weeks of Superintendent	Week	3.0000	\$4,025.00	\$12,075.00	RSM24MCOM L, O&P P
6	01-31-13-30-0050 Insurance, standard builders risk, maximum Project Insurance	Job	120,000.0000	0.8000%	\$960.00	RSM24MCOM O&P P
7	01-31-13-90-0100 Performance Bond, for buildings, maximum Performance Bond	Job	120,000.0000	2.5000%	\$3,000.00	RSM24MCOM O&P P
8	01-45-23-50-8000 X-ray concrete slabs X-Ray of area around each post (6 total)	Ea.	6.0000	\$200.00	\$1,200.00	RSM24MCOM O&P P
9	01-54-33-20-0120-3 Rent per week for rent excavator diesel hydraulic crawler mounted 5/8 CY capacity 1 week rental for mini excavator	Ea.	1.0000	\$2,757.65	\$2,757.65	RSM24MCOM E, O&P P
10	01-54-33-20-0460-3 Rent per week for rent backhoe-loader wheel type 80 HP 1-1/4 CY capacity 2 week rental for backhoe	Ea.	2.0000	\$1,881.32	\$3,762.64	RSM24MCOM E, O&P P
11	01-54-33-40-0960-3 Rent per week for rent air tool, track/wagon drill, swing, 4" drifter 1 week rental for a jackhammer attachment to the mini excavator	Ea.	1.0000	\$3,670.92	\$3,670.92	RSM24MCOM E, O&P P
12	01-56-26-50-0100 Temporary fencing, chain link, 6' high, 11 ga Fence rental for the perimeter of the basketball court during the duration of the project	L.F.	400.0000	\$8.80	\$3,520.00	RSM24MCOM M, L, O&P P
<b>01 - General Requirements Total</b>						<b>\$61,768.21</b>
<b>02 - Existing Conditions</b>						
13	02-31-23-10-0100 Ground Penetrating Radar 4hr minimum	Hr.	4.0000	\$235.00	\$940.00	RSM24MCOM L, O&P P
14	02-41-19-16-1050 Selective demolition, cutout, concrete, elevated slab, bar reinforced, over 6 C.F., excludes loading and disposal	C.F.	30.0000	\$66.50	\$1,995.00	RSM24MCOM L, E, O&P P

# Preliminary Estimate, by estimates

**Estimator: Alex Schies**

**CoCoppell - Andy Browk Park West Bball Courts**

**02 - Existing Conditions**

Item	Description	UM	Quantity	Unit Cost	Total	Book		
Selective concrete demo for area around the existing posts that will be demoed								
15	02-41-19-19-0725	Selective demolition, rubbish handling, dumpster, 20 C.Y., 5 ton capacity, weekly rental, includes one dump per week, cost to be added to demolition cost Concrete handling disposal for the removal of the existing basketball goals, minor concrete, and protective material	Week	3.0000	\$625.00	\$1,875.00	RSM24MCOM M, O&P	P

**02 - Existing Conditions Total** **\$4,810.00**

**03 - Concrete**

16	03-30-53-40-4650	Structural concrete, in place, slab on grade (3500 psi), 4" thick, includes forms(4 uses), Grade 60 rebar, concrete (Portland cement Type I), and placing, excludes finishing Concrete and rebar for pour back where demo occurred	C.Y.	10.0000	\$385.00	\$3,850.00	RSM24MCOM M, L, E, O&P	P
----	------------------	---------------------------------------------------------------------------------------------------------------------------------------------------------------------------------------------------------------------------------------	------	---------	----------	------------	---------------------------	---

**03 - Concrete Total** **\$3,850.00**

**Item Specific Scope & Crews**

17	01-01-01-01-0001	Deduct cents Labor: \$-0.91	Unit	1.0000	\$-0.91	\$(0.91)	CUSTOM L, B	P
18	01-31-13-20-0140	Field personnel, field engineer, senior engineer, maximum Estimator & Project Engineer, half the time Labor: \$3,989.00	Week	1.5000	\$3,989.00	\$5,983.50	CUSTOM L, O&P	P
19	11-66-23-13-1100	School equipment, basketball backstops, steel post, fixed, 6' gooseneck extended, maximum (6) Draper - 5 9/16" Gooseneck Outdoor Basketball System W/ 6' extension, Aluminum Backboard w/ markings, Safety Chain Net Crew: L-02, Output: 1, Labor Hours: 16 Material: \$4,950.00, Labor: \$1,965.00	Ea.	6.0000	\$6,915.00	\$41,490.00	CUSTOM M, L, O&P	P
20	11-66-23-13-1100	Demo - School equipment, basketball backstops, steel post, fixed, 6' gooseneck extended, maximum (6) Draper - 5 9/16" Gooseneck Outdoor Basketball System W/ 6' extension, Aluminum Backboard w/ markings, Safety Chain Net  (Repriced 5/02/2024) Labor Adjustment: 50% of \$1,965.00 = \$982.50 ----- Using O&P Pricing  Crew: L-02, Output: 1, Labor Hours: 16 Labor: \$982.50	Ea.	6.0000	\$982.50	\$5,895.00	CUSTOM L, O&P	P
21	Crew A-01	A-01 Crew - 2024 - RSMMeans Standard Books O&P Two laborers for demoing existing basketball goals, avg one per day  A-01 (2024 - RSMMeans Standard Books) Labor Hours: 16	Daily	6.0000	\$1,292.05	\$7,752.30	CUSTOM L, E, O&P	P

# Preliminary Estimate, by estimates

**Estimator: Alex Schies**

**CoCoppell - Andy Browk Park West Bball Courts**

**Item Specific Scope & Crews**

Item	Description	UM	Quantity	Unit Cost	Total	Book
	Equip Hours: 8 Daily Hours: 8  Crew Details: Code: CLAB Description: Common Building Laborers Qty: 2 Hourly: 722.55 Daily: 580.4 Code: 015433102600 Description: Concrete Saw, Gas Manual Qty: 1 Hourly: 0 Daily: 131.25 Crew: A-01, Labor Hours: 8 Labor: \$1,160.80, Equip: \$131.25					
22 Crew B-66	B-66 Crew - 2024 - RSMMeans Standard Books O&P Equipment Operator for the rental machinery  B-66 (2024 - RSMMeans Standard Books) Labor Hours: 8 Daily Hours: 8  Crew Details: Code: EQLT Description: Equipment Operators, Light Equipment Qty: 1 Hourly: 91.95 Daily: 735.6 Crew: B-66, Labor Hours: 8 Labor: \$735.60	Daily	6.0000	\$735.60	\$4,413.60	CUSTOM L, O&P P
23 Crew C-04A	C-04A Crew - 2024 - RSMMeans Standard Books O&P Rebar installers  C-04A (2024 - RSMMeans Standard Books) Labor Hours: 16 Daily Hours: 16  Crew Details: Code: RODM Description: Rodmen (Reinforcing) Qty: 2 Hourly: 100 Daily: 1600  Crew: C-04A, Labor Hours: 16 Labor: \$1,600.00	Daily	2.0000	\$1,600.00	\$3,200.00	CUSTOM L, O&P P
24 Crew C-27	C-27 Crew - 2024 - RSMMeans Standard Books O&P Concrete finishers following the basketball goal installs  C-27 (2024 - RSMMeans Standard Books) Labor Hours: 16 Daily Hours: 16  Crew Details: Code: CEFI Description: Cement Finishers Qty: 2 Hourly: 82.8 Daily: 1324.8  Crew: C-27, Labor Hours: 16 Labor: \$1,324.80	Daily	2.0000	\$1,324.80	\$2,649.60	CUSTOM L, O&P P

# Preliminary Estimate, by estimates

Estimator: Alex Schies

CoCoppell - Andy Browk Park West Bball Courts

Item Specific Scope & Crews

Item	Description	UM	Quantity	Unit Cost	Total	Book
<b>Item Specific Scope &amp; Crews Total</b>						\$71,383.09
<b>Estimate Grand Total</b>						<b>119,615.00</b>



# EZ-Fold® 5065XY

Outdoor Backstop—5 9/16" Gooseneck Post with 6' Extension

## SUBMITTAL & TECHNICAL INFORMATION

### Product Description

Basketball Backstop shall be the 5065XY Outdoor Backstop by Draper, Inc. Spiceland, IN. 5065XY Backstop shall have a 5 9/16" OD heavy-wall galvanized post with an approximate 24" radius to extend the face of the backboard 6'0" from the front edge of the post. The backboard and goal bolt directly to the post nose plate forming a solid unit that transfers loads to the heavy-duty steel post to eliminate strain on the backboard.

XY indicates the backboard and goal. Backstop available with a variety of backboards and goals per charts below and posts have a hot dipped galvanized finish. Design shall be a bent gooseneck style and allow for a 48" bury into the ground and a 72" extension from the front of the pole to the face of the backboard. Two 1 5/8" diameter, 13 ga. flow coated galvanized tubular braces shall support the top of the backboard and connect directly to the pole.

Pole shall be designed so that the rim mounts directly to the nose plate attached to the horizontal pole section through the backboard to eliminate stress on the backboard during play. Pole systems without backboard support braces shall not be considered equal.

See appropriate submittal documents for selected backboard and goal.

Installation to be completed in accordance with manufacturer's instructions. Do not scale drawings. Entire system shall weigh 360#.

### Please Mark Appropriate Selections

#### Select Backboard (X)

- 503148 Fan Fiberglass Backboard
- 503143 Fan Aluminum Backboard—Border and Target
- 503167 Rectangular Steel Backboard Border and Target
- 503034 72" x 42" Rectangular Polycarbonate Backboard
- 503035 54" x 42" Rectangular Polycarbonate Backboard

#### Select Goal (Y)

- 503572 Heavy Duty Stationary Goal with Nylon Net
- 503575 Double Rim Goal with Nylon Net
- 503579 Double Rim Goal with Chain Net
- 503077 Super Goal with Premium Chain Net
- 503078 Super Goal with Nylon Net
- 503079 Outdoor Breakaway Goal with Nylon Net

#### Optional Goalpost Pads

- 506985 Outdoor Backstop Pad

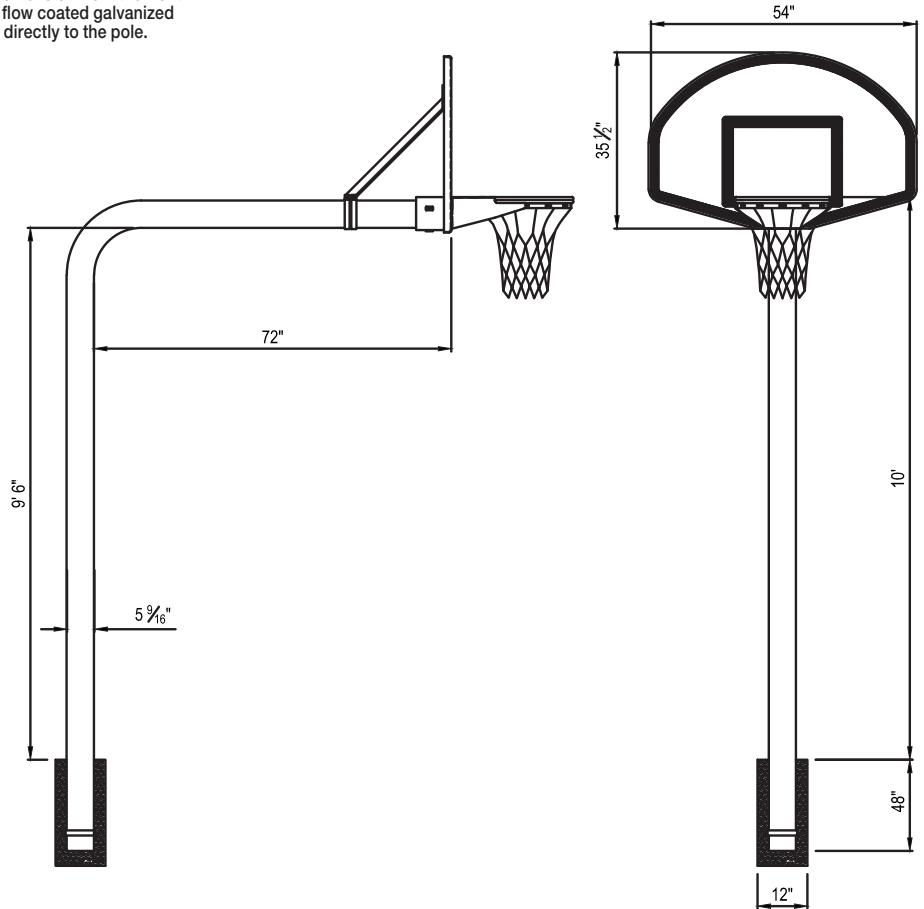

X = Backboard		
"X"	Part No.	Description
1	503148	Fan Fiberglass
4	503143	Fan Aluminum—Border and Target
5	503167	72" x 42" Steel with Border and Target
7	503035	54" x 42" Polycarbonate
8	503034	72" x 42" Polycarbonate

Y = Goal		
"Y"	Part No.	Description
2	503572	Heavy Duty Stationary Goal with Nylon Net
3	503575	Double Rim Goal with Nylon Net
4	503579	Double Rim Goal with Chain Net
5	503078	Super Goal with Nylon Net
6	503077	Super Goal with Premium Chain Net
7	503079	Outdoor Breakaway Goal with Nylon Net

PROJECT: \_\_\_\_\_

ARCHITECT: \_\_\_\_\_

CONTRACTOR: \_\_\_\_\_

SUPPLIER: \_\_\_\_\_

DATE: \_\_\_\_\_ REVISED: \_\_\_\_\_



Draper, Inc. | 411 S. Pearl St. Spiceland, IN 47385  
draperinc.com | 765.987.7999 | 800.238.7999

© 2018 All Rights Reserved | FORM: EZ-5065XY\_Sub18

# EZ Fold<sup>®</sup> 503077

Super Playground Basketball Goal  
with Premium Chain Net

by DRAPER

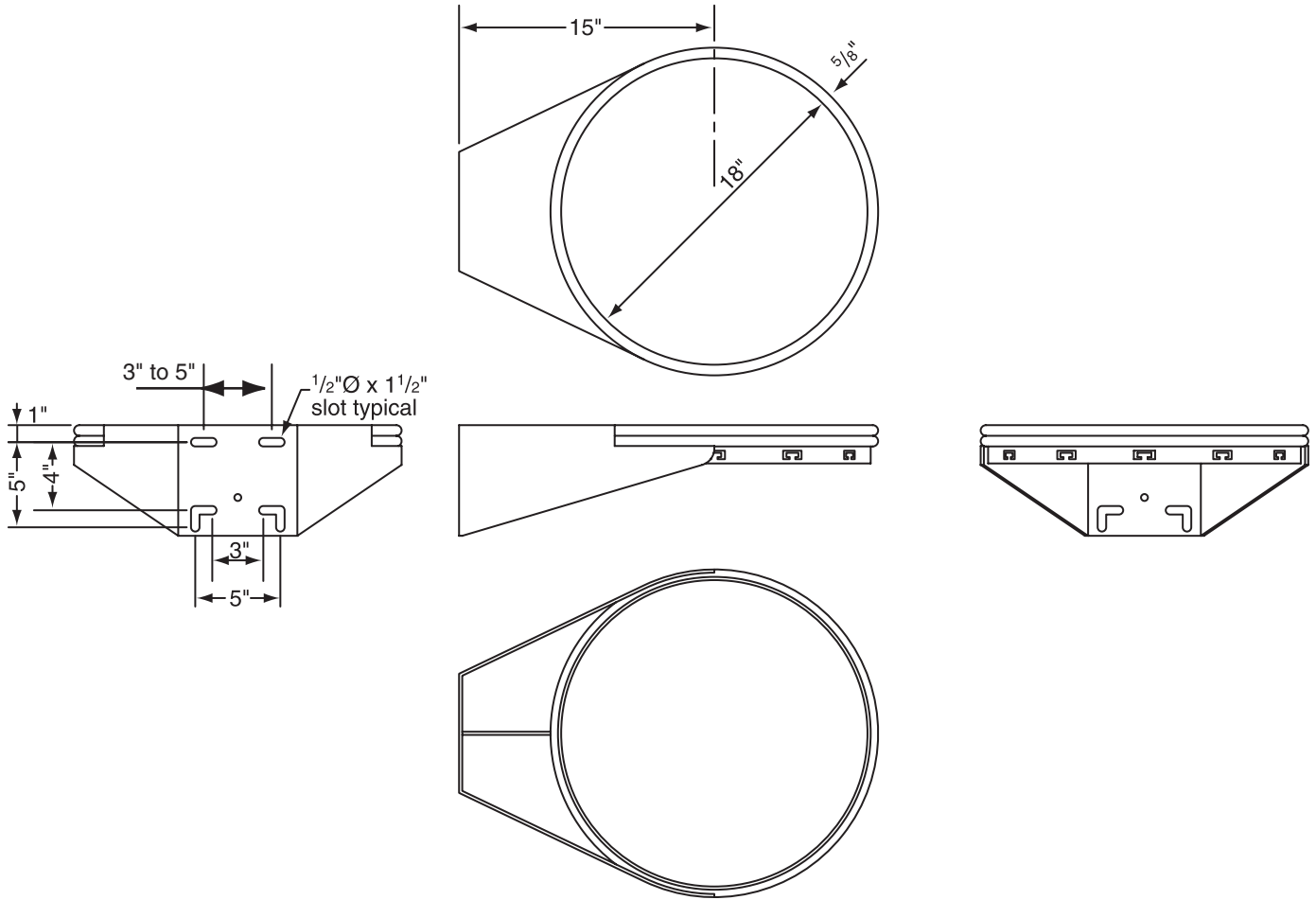

## Specifications—EZ Fold 503077 Super Playground Basketball Goal with Premium Chain Net

### Product Description

Goal shall consist of two  $\frac{5}{8}$ " diameter high strength steel rings welded together at a minimum of six places. Back, side and center gusset plates shall be  $\frac{3}{16}$ " thick and be continuously welded. The net attachment system shall be of a continuous type constructed of  $\frac{3}{16}$ " x 1" steel with punched net attachment slots suitable for nylon or chain nets. Rim shall be punched to mount on any front mount backboard and shall have an orange powder coated finish. Grade 5 mounting hardware shall be included.

Goal provided with Premium Steel Net. Net shall be constructed entirely of welded link smooth chain. Chain wire diameter shall be no less than .133". Net assembly shall include no more than two non-welded links and result in rectangular net openings that reduce the risk of hand or finger entrapment. Net shall attach to the rim by means of twelve S-hooks that are no less than .188" diameter. Net and S-hooks shall be zinc plated.

Goal shall weigh approximately 30 lbs. and is covered an Unconditional Lifetime Warranty. Premium Steel Chain Net covered by 2-year limited warranty.

DRAPER

411 S. Pearl St., Spiceland, IN 47385 USA ■ 765-987-7999 ■ fax 765-987-7142  
www.draperinc.com

Copyright © 2004 Draper Inc. Form EZ-503077\_Sub04 Printed in U.S.A.

PROJECT: \_\_\_\_\_

ARCHITECT: \_\_\_\_\_

CONTRACTOR: \_\_\_\_\_

SUPPLIER: \_\_\_\_\_

DATE: \_\_\_\_\_ REVISED: \_\_\_\_\_

# EZ Fold® 503143

Official 54" x 35½" Fan  
Aluminum Basketball Backboard  
with Competition Striping

by DRAPER

## Specifications—EZ Fold 503143

Official 54" x 35½"

Fan Aluminum Basketball Backboard with  
Competition Striping

### Product Description

503143 Cast aluminum backboard shall be official size (54" x 35½") and shape. For use with EZ Fold indoor or outdoor backstops. Bank shall be cast in a permanent mold process from high tensile #319 aluminum.

Backboard shall be cast with structural reinforcing ribs on backside with a heavy, 1<sup>3</sup>/<sub>8</sub>" deep perimeter flange to provide maximum strength. Back side of bank shall be furnished with twelve (12) tapped holes (3/8"-16) to fit standard mounting attachment without exposed bolt heads on face of backboard.

Backboard shall be finished with a special white, non-glare enamel, with orange perimeter and target area competition striping.

Backboard shall be drilled for a front mount type goal (5" horizontal x 4½" vertical).

### Lifetime Limited Warranty.

Backboard shall be covered by a Lifetime Limited Warranty. Contact Draper to request full warranty text.

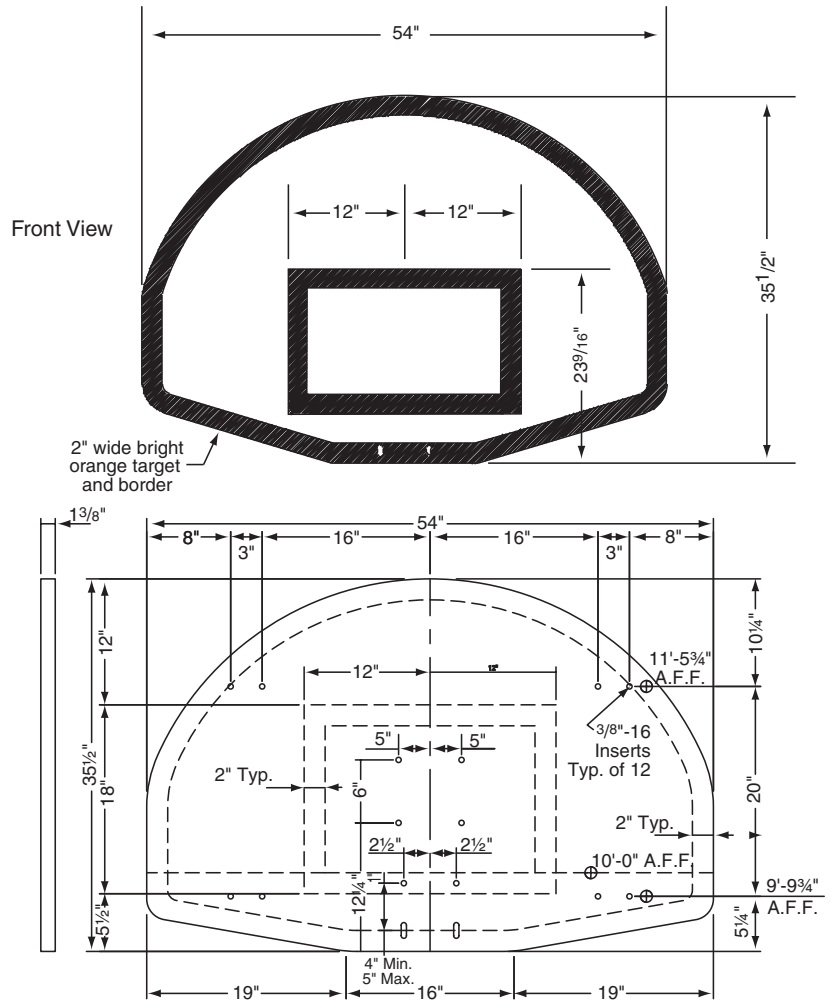

DRAPER®

411 S. Pearl St., Spiceland, IN 47385 USA ■ 765-987-7999  
www.draperinc.com ■ fax 866-637-5611  
Copyright © 2010 Draper Inc. Form EZ-503143\_Sub10 Printed in U.S.A.

PROJECT: \_\_\_\_\_

ARCHITECT: \_\_\_\_\_

CONTRACTOR: \_\_\_\_\_

SUPPLIER: \_\_\_\_\_

DATE: \_\_\_\_\_ REVISED: \_\_\_\_\_