

Lakeside ES - Exterior Materials

25227.0000, LAKESIDE ELEMENTARY SCHOOL – RENOVATIONS AND ADDITIONS

Date Issued: 8/7/2025 4:00 PM

To: Mary Paron-Boswell
Sr. Planner
City of Coppell
265 Parkway Blvd.
Coppell, TX, 75019

EXTERIOR BUILDING MATERIALS

Brick 1: Interstate Brick – Platinum Matte (to match existing)

Brick 2: Glen Gery – Granite Red Velour (to match existing)

Metal Panel: Alucobond – Native Copper Mica (front canopy)

Storefront System: Kawneer – Dark Bronze 40 (to match existing)

Existing Building Height: 35'

Proposed Building Height: 35'

Façade Material Breakdown

Metal Panel: **1.2%**

Storefront: **13.8%**

Masonry: **85.0%**

CC:

Attachments: Lakeside ES Elevations

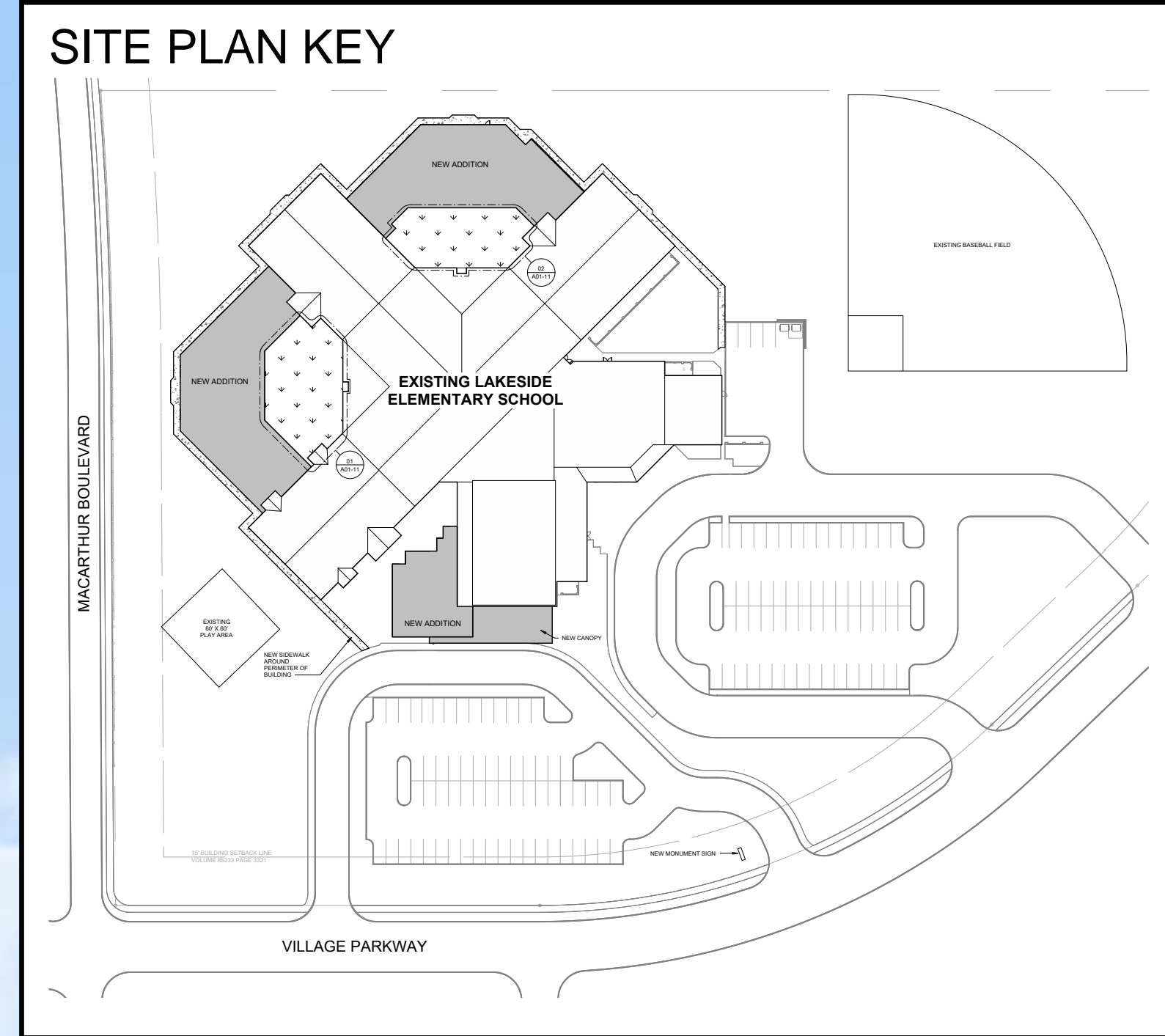

LAKESIDE ELEMENTARY SCHOOL

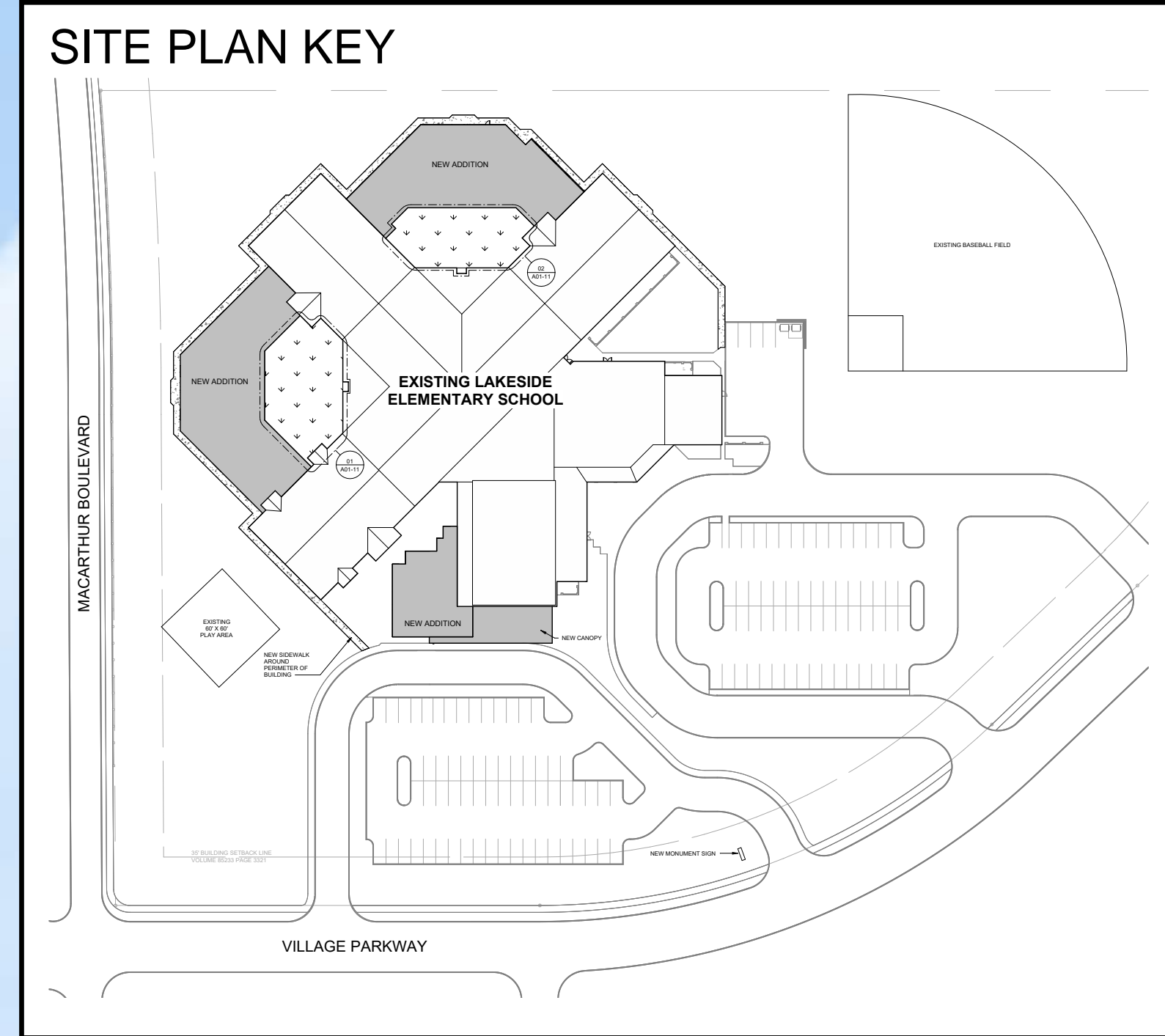



SITE PLAN KEY

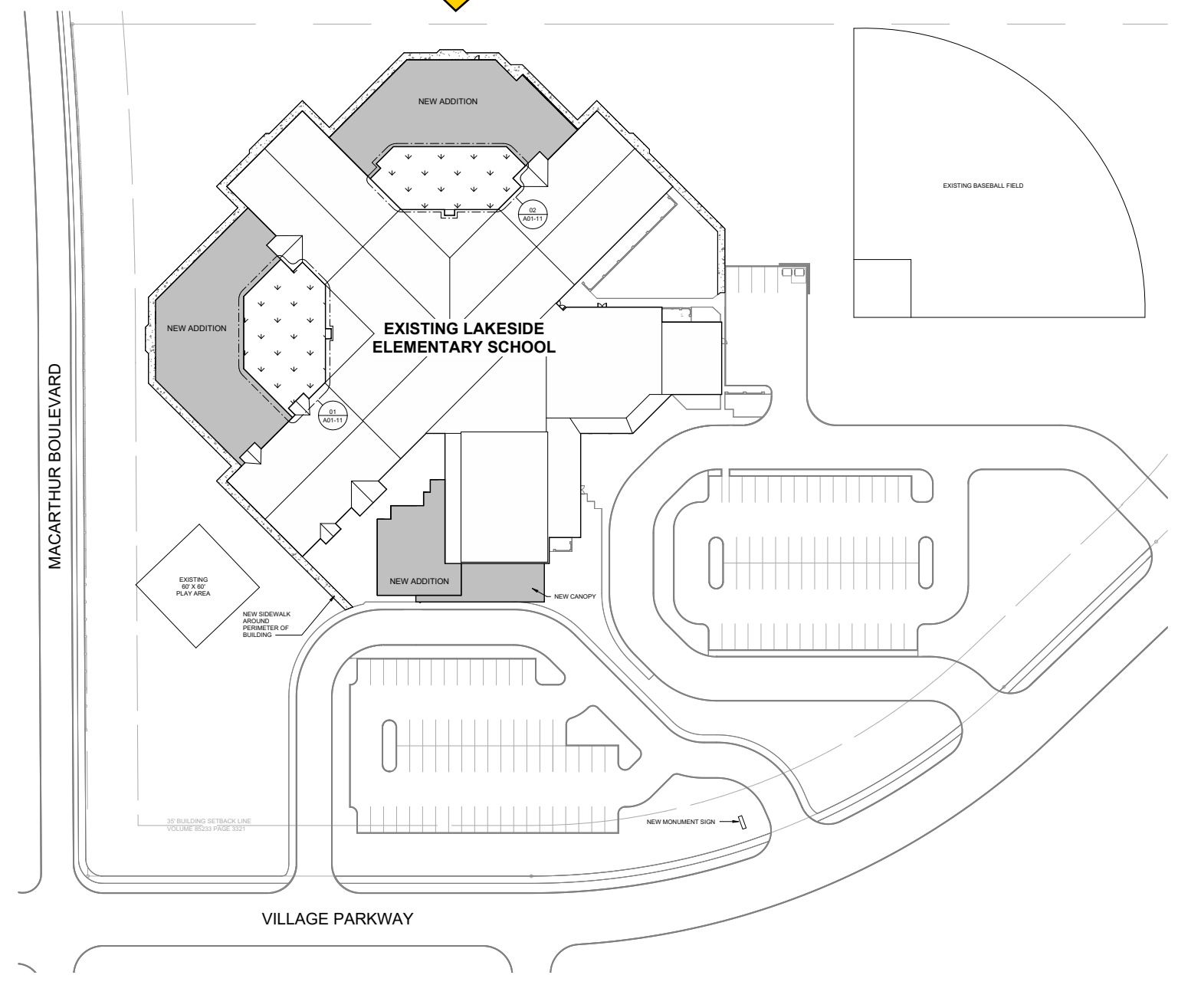

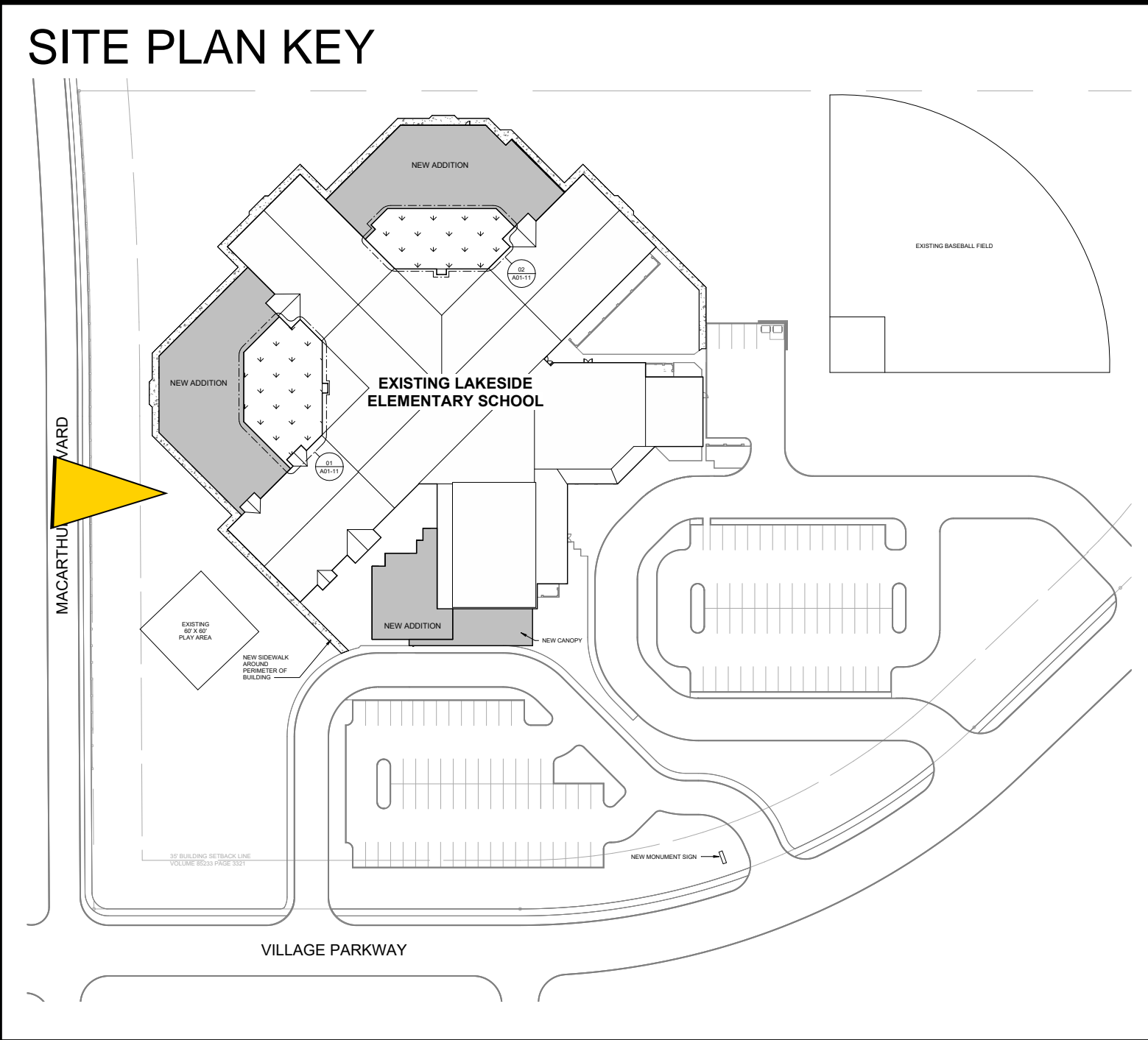

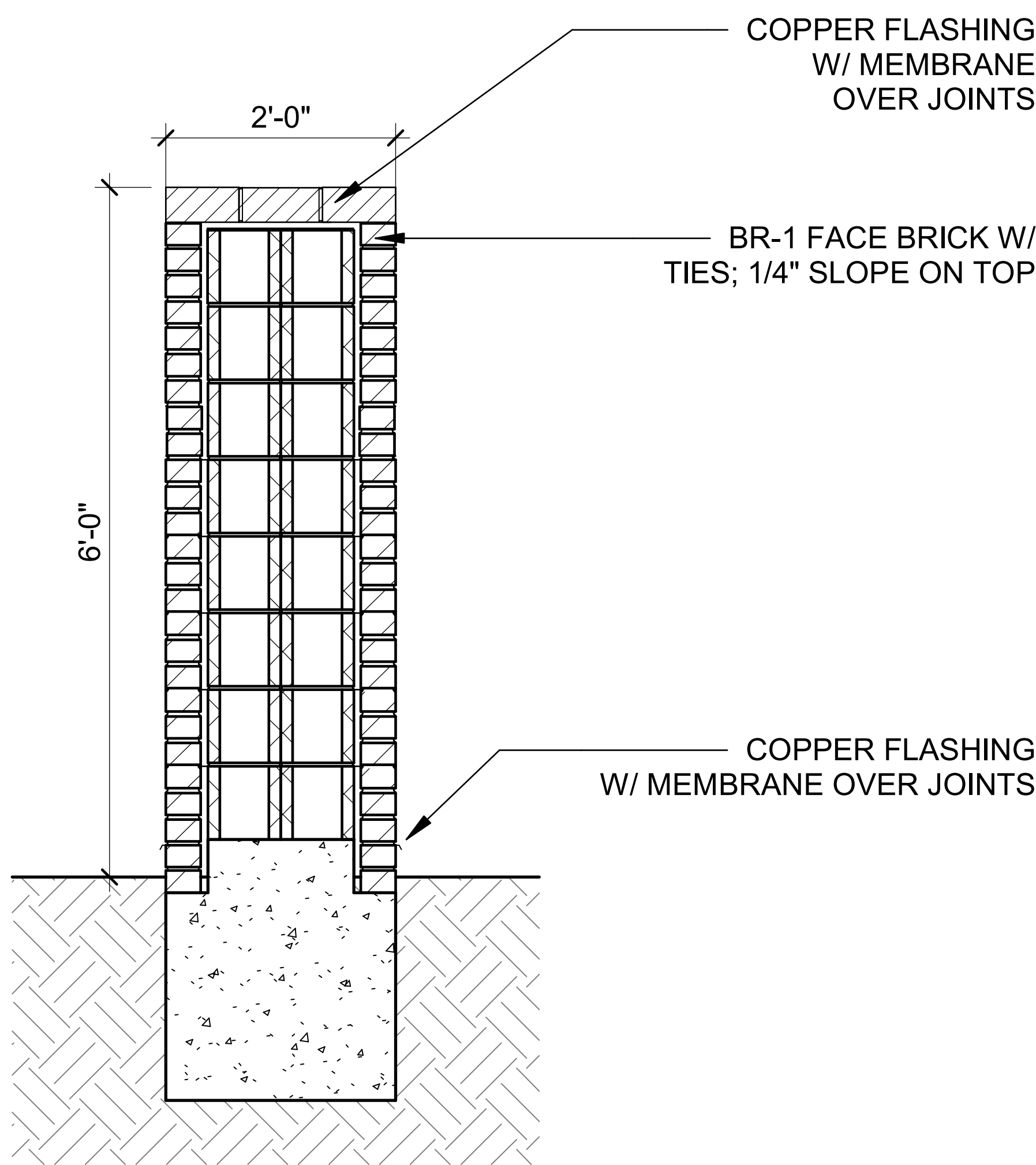

08 MARQUEE SIGN SECTION
1/2" = 1'-0"

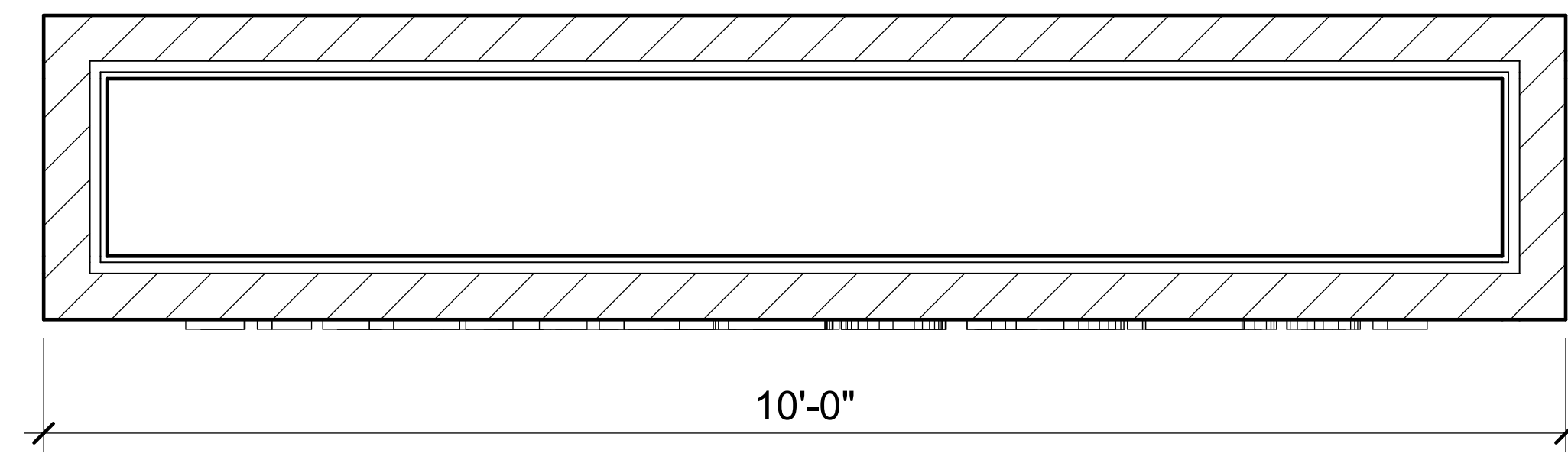

07 ENLARGED SITE PLAN - MARQUEE SIGN
1/2" = 1'-0"

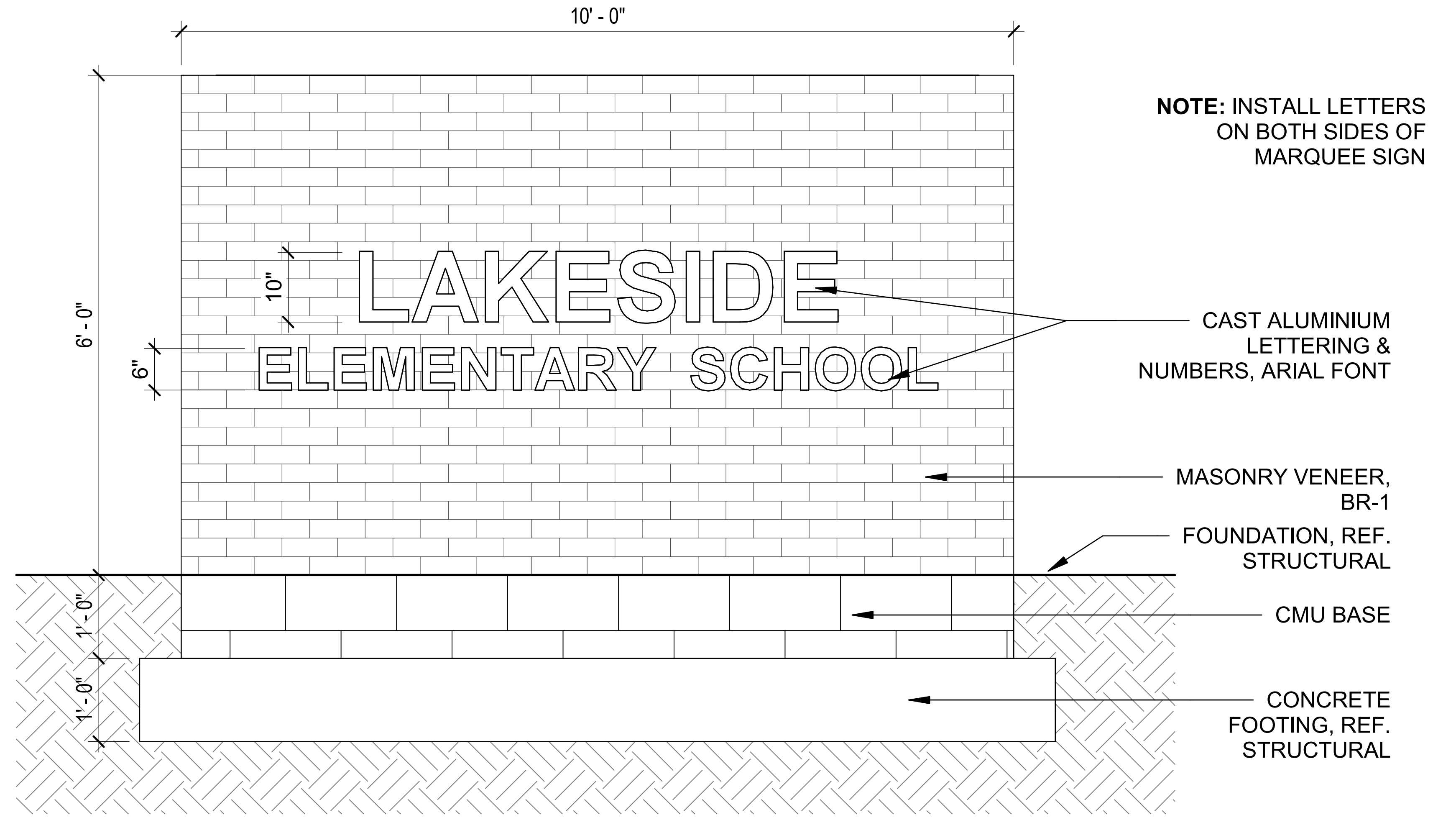

06 EXTERIOR ELEVATION - MARQUEE SIGN
1/2" = 1'-0"