

ARCHITECTURAL PLANNING SUMMARY – PHASE 1

WILLIAM T. COZBY PUBLIC LIBRARY

PROPOSED SITE PLAN to include:

- Drive-Up Book Drop
- Pick-up/Drop-off Lane
- Outdoor Children Courtyard
- Outdoor Seating / Social Gathering at Front Entry Plaza
- Additional land req'd from Town Center Elementary to accommodate req'd parking for expansion / drive-up book and traffic flow

DRAFT

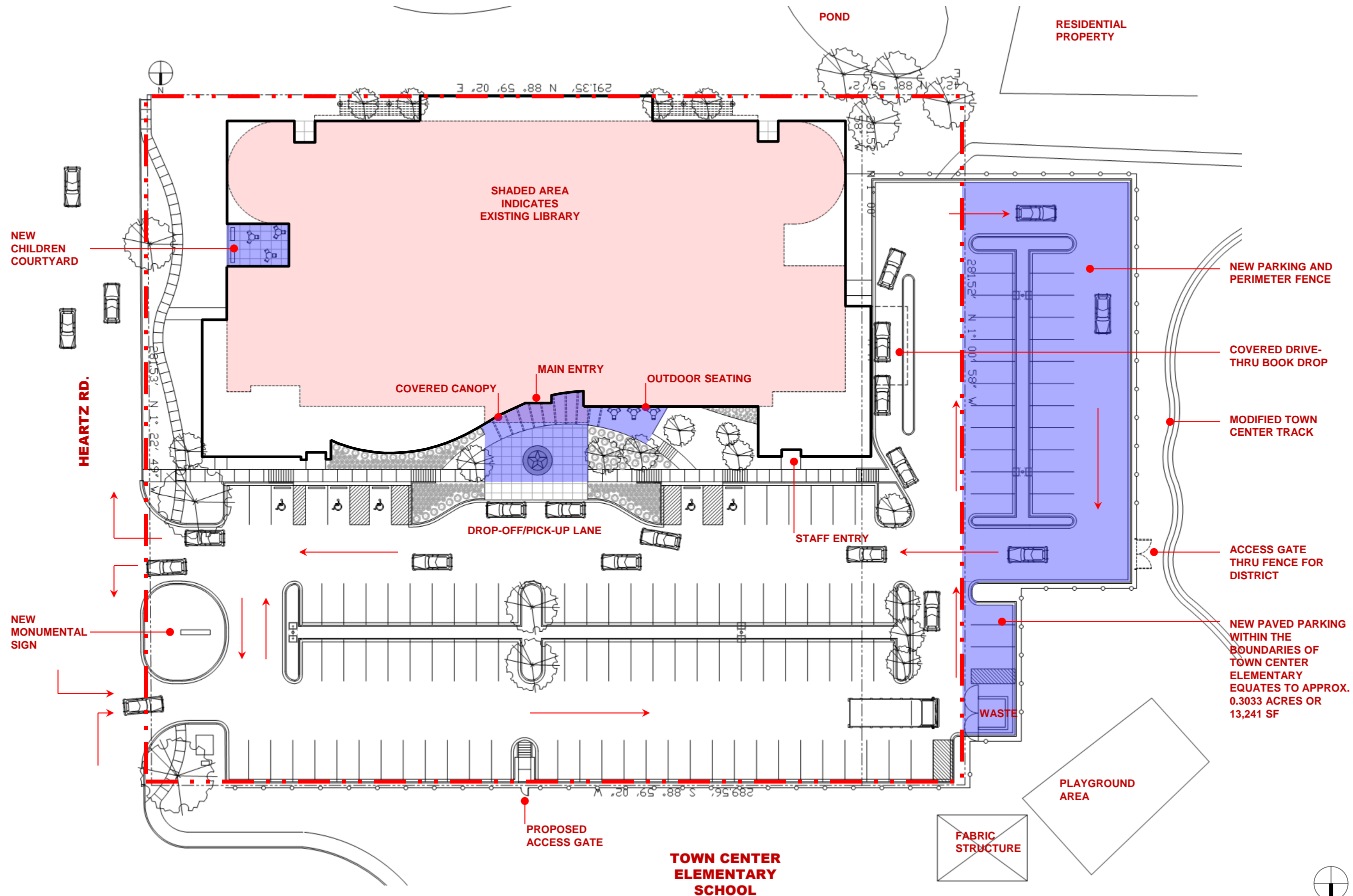

The amount of
space **DEDICATED**
to PUBLIC USE
for Programs,
Services,
Technology, Social
Gathering, Meeting,
Business and Study

equals
74%

NEW CONCEPTUAL FLOOR PLAN

33,479 SF

DRAFT

ARCHITECTURAL PLANNING SUMMARY – PHASE 1

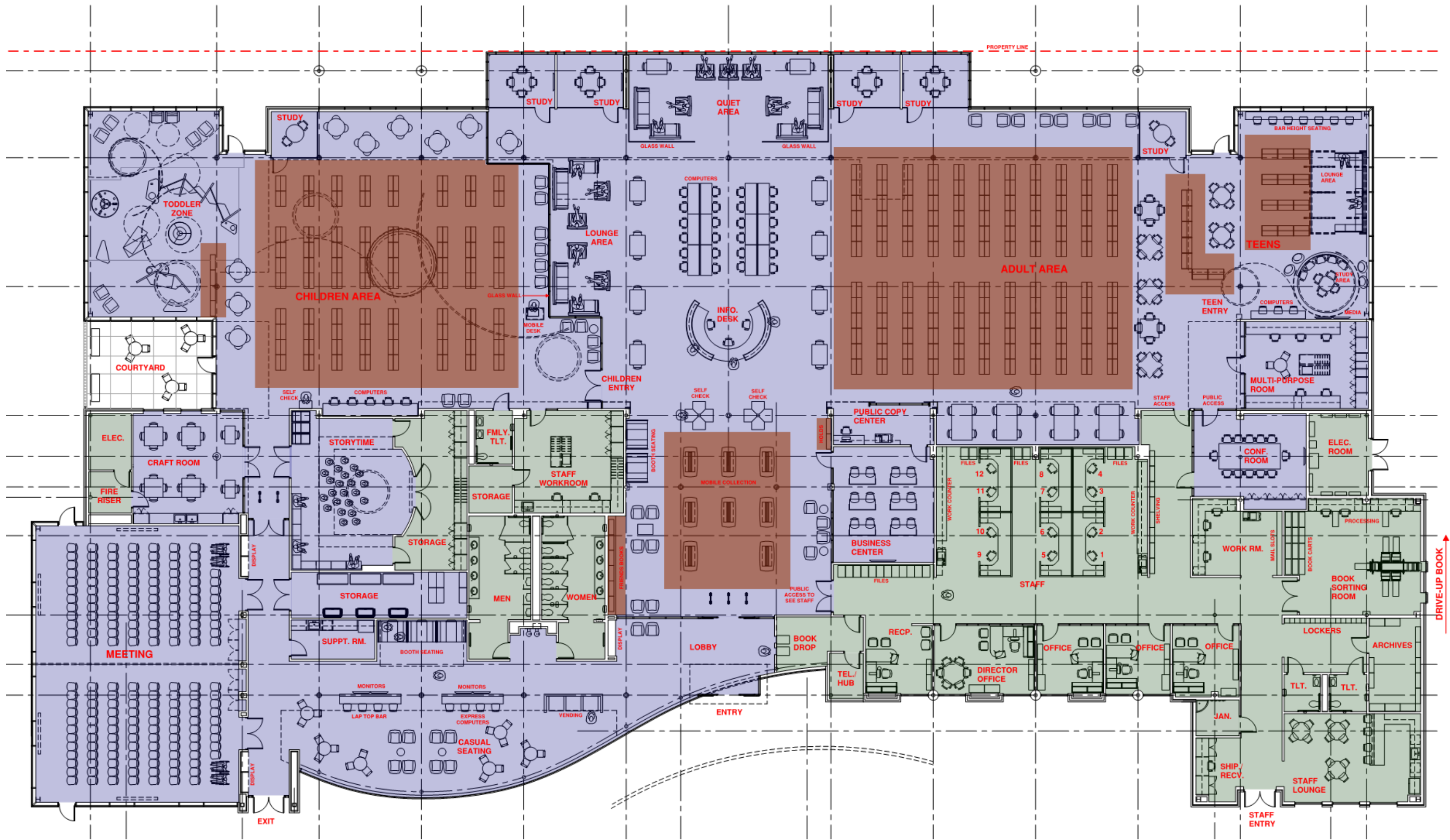

TRADITIONAL LIBRARY
MEETING / GATHERING SPACES
SHARED SPACE



WILLIAM T.
COZBY
PUBLIC
LIBRARY

BUILDING
PROGRAM
of SPACES

ARCHITECTURAL PLANNING SUMMARY – PHASE 1



Square Footage Breakdown				Summary	
1. PUBLIC ENTRANCE/LOBBY		6. ADULT SERVICES		EXISTING EXPANSION	28000 SF <u>5479 SF</u>
MAIN BUILDING ENTRANCE	479	ADULT COLLECTION AREA	3754		
CASUAL SEATING AREA	1668	ADULT SEATING AREA	4750		
PUBLIC RESTROOMS	<u>619</u>	ADULT TECHNOLOGY AREA	<u>527</u>	NEW BUILDING	33479 SF
SUBTOTAL	2766	SUBTOTAL	9031		
2. PUBLIC MEETING SPACES		7. STAFF SERVICES			
LARGE MEETING ROOM(S)	2166	STAFF CUBICLE AREA	2133	<div>The amount of space DEDICATED to PUBLIC U for Programs, Services Technology, Social Gather Meeting, Business and St</div>	
2-PERSON STUDY ROOM (CHILDREN)	81	BOOK DROP ROOM (INTERIOR)	147		
2-PERSON STUDY ROOM (ADULT/TEEN)	81	RECEPTIONIST	173		
4-PERSON STUDY ROOM	134	DIRECTOR OFFICE	259		
4-PERSON STUDY ROOM	134	OFFICE	173		
4-PERSON STUDY ROOM	134	OFFICE	170		
4-PERSON STUDY ROOM	134	OFFICE	180		
14(+) CONFERENCE ROOM	389	WORK ROOM	241		
SUPPORT ROOM (KITCHENETTE)	124	BOOK SORTING ROOM	567		
STORAGE (SERVING MEETING ROOMS)	<u>307</u>	STAFF LOUNGE	458		
SUBTOTAL	3684	SHIPPING/RECEIVING	104	<div>equals</div> <div>22,731 SF</div> <div>or</div> <div>74%</div> <div>of the NET SF</div>	
3. CHILDREN SERVICES		LOCKER AREA	172		
CHILDREN COLLECTION AREA	2421	STAFF TOILET (M)	51		
CHILDREN SEATING AREA	1151	STAFF TOILET (F)	51		
TODDLER ZONE	1030	ARCHIVES	<u>185</u>		
CRAFT ROOM	464	SUBTOTAL	5064		
STORY TIME	642	8. SUPPORT SERVICES			
STORAGE off of STORY TIME	372	MAIN ELECTRICAL ROOM	184		
FAMILY TOILET	74	ELECTRICAL ROOM	92		
CHILDREN WORKROOM	423	FIRE RISER ROOM	67		
STORAGE off of CHILDREN WORKROOM	<u>77</u>	JANITOR CLOSET	59		
SUBTOTAL	6654	TELE./HUB	<u>59</u>		
4. TEEN SERVICES		SUBTOTAL	461	<div>22,731 SF</div> <div>or</div> <div>74%</div> <div>of the NET SF</div>	
TEEN COLLECTION AREA	204	NET SQUARE FEET	30731		
TEEN LOUNGE/STUDY/SEATING AREA	<u>1193</u>	UNASSIGNABLE	<u>2748</u>		
SUBTOTAL	1397	GROSS SQUARE FEET			
5. SPECIAL SERVICES		33479			
MULTI-PURPOSE ROOM	406				
DIGITAL LAB / RECORDING STUDIO					
MAKER SPACE					
BUSINESS CENTER	446				
TRAINING ROOM					
CLASSROOM					
COMPUTER LAB					
PUBLIC COPY CENTER	162				
QUIET READING AREA	<u>660</u>				
SUBTOTAL	1674				

The amount of space
DEDICATED to PUBLIC USE
for Programs, Services,
Technology, Social Gathering,
Meeting, Business and Study

equals

22,731 SF

or

74%

of the NET SF