

Concept Landscape Plan
Scale: 1" = 60'

Drawing Key

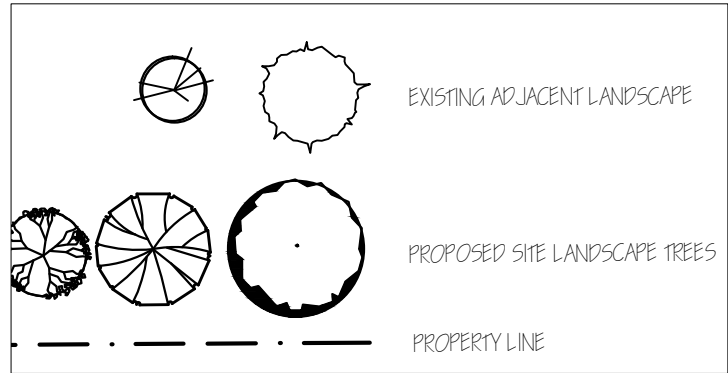

Jurisdiction of Project

REGULATORY AUTHORITIES:
CITY OF COPPELL PLANNING & ZONING
255 PARKWAY BLVD.
PO BOX 9478
COPPELL, TX 75019
972 304-7092
TEXAS DEPARTMENT OF LICENSING AND REGULATION
ELIMINATION OF ARCHITECTURAL BARRIERS
E.O. THOMPSON STATE OFFICE BUILDING
920 COLORADO
AUSTIN, TEXAS 78701
(512) 463-3211
(512) 475-2886 (FAX)

Landscaping Requirements

CITY OF COPPELL LANDSCAPE REQUIREMENTS
ARTICLE 54. LANDSCAPE REGULATIONS
SEC. 12-34

NO EXISTING TREES ON SITE.

Irrigation Requirements

UNDERGROUND AUTOMATIC SPRINKLING SYSTEM PROVIDED.
SYSTEM DESIGNED AND INSTALLED ACCORDING TO TCEQ LAWS AND
REGULATIONS PROVIDING FOR 100% COVERAGE ON ALL LANDSCAPE AND TURF.
THE SYSTEM SHALL INCLUDE A DROVE-RAIN SENSOR.

Site Location

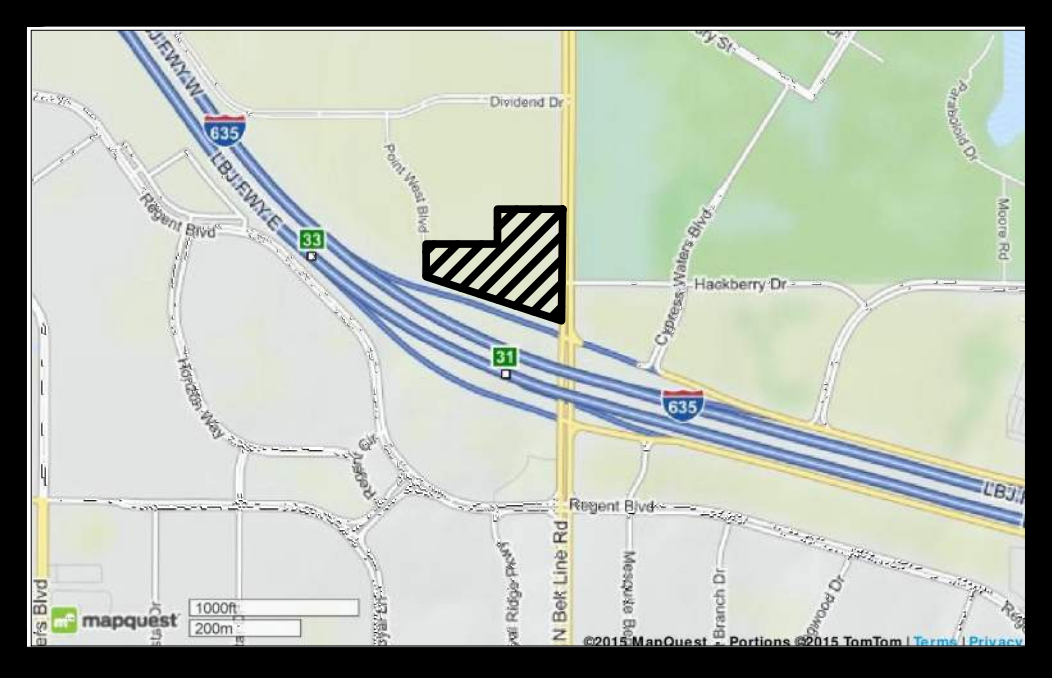

These drawings have been prepared by or under the supervision of Carol Feldman, Registered Landscape Architect #2080, Licensed Irrigator LI #20245

SITE
LOT 1 BLOCK C
DUKE LESLEY ADDITION
DIVIDEND DRIVE & POINT WEST BOULEVARD
INST. #20070240528
D.R.D.C.T.

VACANT TRACT 757,425 SF 17.3881 AC
AS SURVEYED

SEPTEMBER 2015

ZONING: PD PLANNED DEVELOPMENT

FEMA MAP
AREA OF MINIMAL FLOOD HAZARD
ZONE X
PANEL 48121C0725G

OWNER & PROFESSIONALS
OWNER
SUN HOLDINGS, INC
3318 FOREST LN.
DALLAS, TX
ARMANDO PALACIOS
(214) 551-0921
APALACIOS@SUNHOLDINGS.NET
ARMANDO LOPEZ
(210) 889-3084
ALOPEZ@SUNHOLDINGS.NET

LANDSCAPE ARCHITECT
FELDMAN DESIGN STUDIOS
PO BOX 834326
RICHARDSON, TEXAS 750803
CAROL FELDMAN
972 980-1730
CAROL@FELDMANDESIGN.COM

#	REVISIONS
1	SITE PLAN REVISIONS 10.5.15
2	SITE PLAN REVISIONS 12.21.15
3	SITE PLAN REVISIONS 1.7.16
4	SITE PLAN REVISIONS 1.11.16
5	MINOR WORD REVISION 1.19.16
6	SITE PLAN REVISION 1.27.16

OWNER:

PROJECT:

DRAWING TITLE:

DRAWN BY: DESIGNED BY:

DATE: Jan 27, 2016 - 11:25am

PROJECT #:

SHEET #: