

Luminaire Schedule						
Symbol	Qty	Label	Arrangement	Total Lamp Lumens	LLF	Description
	9	L-25	SINGLE	N.A.	0.800	TRP2-D-20-4K7-FT / HUBBELL FORWARD THROW WALLPACK, FULL CUT-OFF. MOUNT AT 12' HEIGHT.
	1	L-30	SINGLE	N.A.	0.900	DSX1 LED P6 40K T3M EGS / LITHONIA TYPE III LUMINAIRE WITH EXTERNAL GLARE SHIELD. MOUNT ON 25' DARK BRONZE POLE.
	1	L-31	BACK-BACK	N.A.	0.900	DSX1 LED P6 40K T3M / LITHONIA TYPE III LUMINAIRE. MOUNT ON 25' DARK BRONZE POLE.
	3	L-33	3 @ 90 DEGREES	N.A.	0.900	DSX1 LED P6 40K T5M / LITHONIA TYPE V LUMINAIRE. MOUNT ON 25' DARK BRONZE POLE.

Calculation Summary							
Label	CalcType	Units	Avg	Max	Min	Avg/Min	Max/Min
50' ATM RADIUS	Illuminance	Fc	5.52	12.8	2.9	1.90	4.41
LIGHT SPILL	Illuminance	Fc	0.27	0.6	0.1	2.70	6.00
PROPERTY LINE	Illuminance	Fc	1.25	2.2	0.5	2.50	4.40
Site Planar	Illuminance	Fc	4.93	13.1	1.9	2.59	6.89

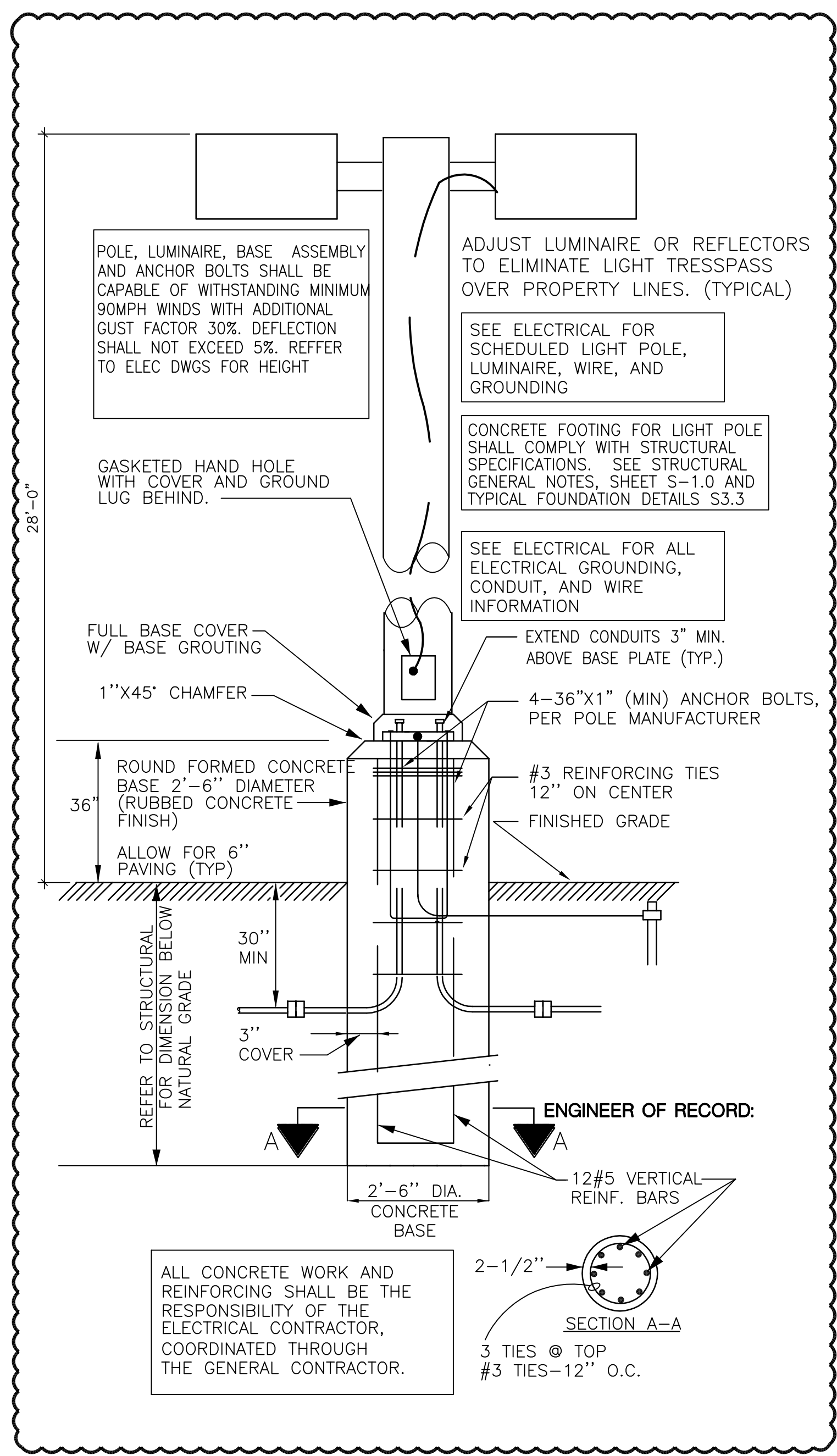
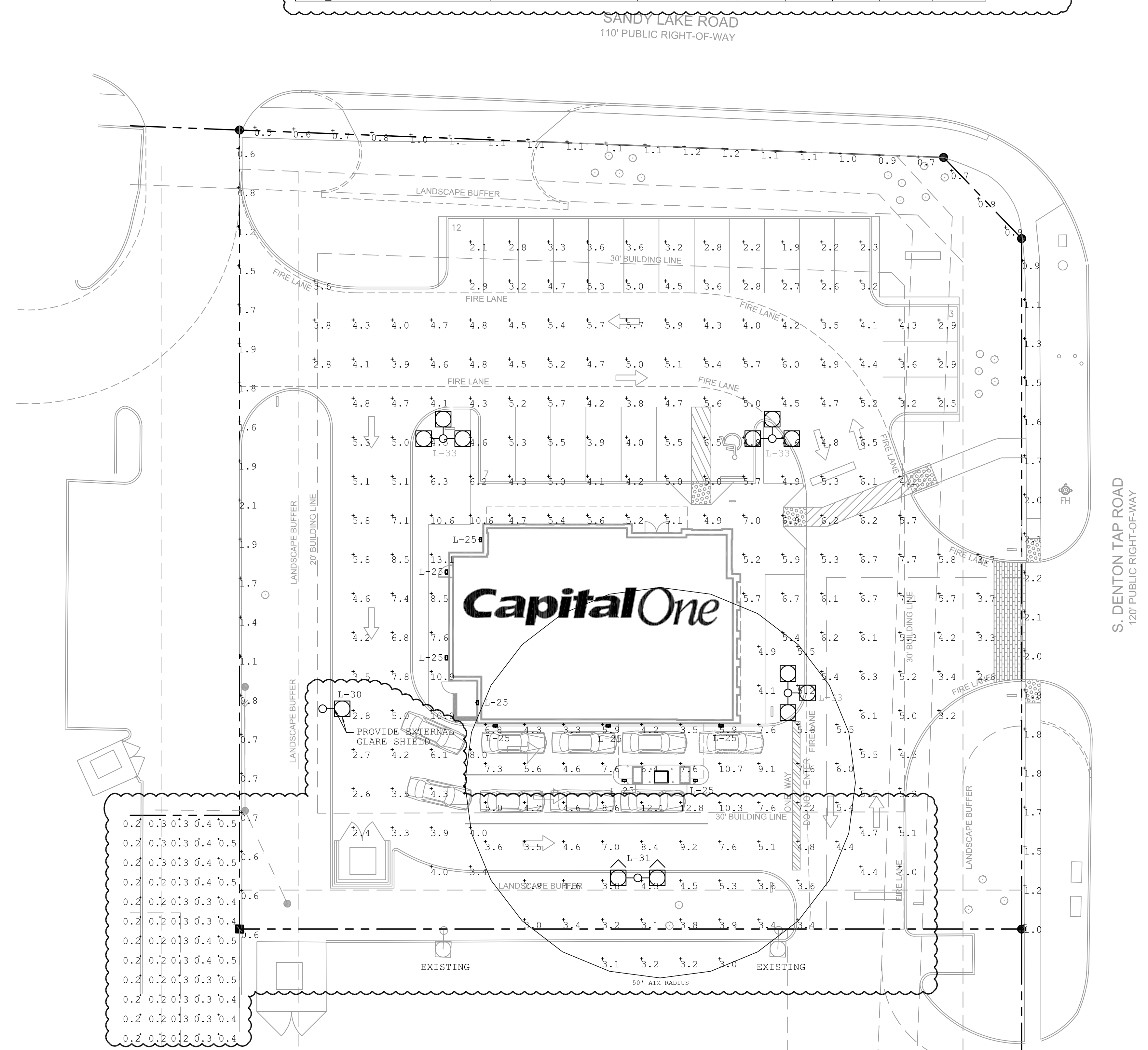

Capital One
Design//Branch Cafe Care & Const.
299 Park Ave. 22nd floor
New York , NY. 10171

CAPITAL ONE BANK
COPPELL

SANDY LAKE CROSSING
LOT 3, BLOCK 1
0.92 AC 39,999 SF, ZONING: "R"
EDWARD A. CROW SURVEY, ABSTRACT NO. 301
105 SOUTH DENTON TAP ROAD
COPPELL, TEXAS 75019

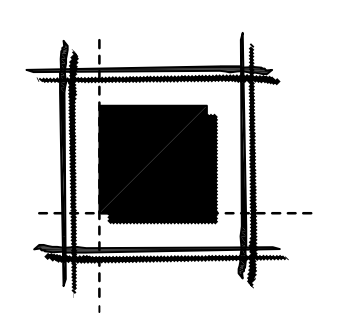

LEVINSON • ALCOSER
ASSOCIATES, L. P.

1177 W. Loop South, Suite 900 Houston, Texas 77027
tel 713.787.0000 fax 713.850.8250

Architecture • Planning • Interior Design

DRAWN BY: LT CHECKED BY: JZ REVISED BY: JZ

REVISIONS	REV.BY:

Copyright 2018 Levinson Alcoser Assoc. Warning: This document is protected by U.S. Copyright Law Under Section 102 of the U.S. Copyright Act and the Architectural Works Copyright Protection Act of 1990. Unauthorized reproduction and distribution of this document or any portion of it, other than for use of this particular project, is prohibited and may result in severe civil and criminal penalties, and will be prosecuted to the maximum extent possible under the law.

SITE 18-07-000261
P&Z SUBMITTAL
08/07/2018

LAALP Project Number: 2018-108.003

E1.01 ELECTRICAL SITE PLAN	
Issued For Bid:	X
Issued For Permit:	X
Issued For Construction:	X

1 ELECTRICAL PHOTOMETRIC SITE PLAN
SCALE: 1/16" = 1'-0"

INTERIM REVIEW
DOCUMENTS

THE DESIGN DOCUMENTS DEPICTED HEREIN ARE FOR THE PURPOSE OF REVIEW AND MAY NOT BE USED FOR REGULATORY APPROVAL, PERMIT, OR CONSTRUCTION UNDER THE AUTHORITY OF MELVIN KALMANS, P.E. TX. REGISTRATION NO. 24070 ON AUGUST 07, 2018

SALASO'BRIEN
[expect a difference]

10930 W. Sam Houston Parkway N., Suite 900
Houston, Texas 77064
281.664.1900 | Registration No. F-4111
Project No. 169-180638



D-Series Size 1 LED Area Luminaire

d#series



Specifications

EPA:	1.01 ft ² (0.09 m ²)
Length:	33" (83.8 cm)
Width:	13" (33.0 cm)
Height:	7-1/2" (19.0 cm)
Weight (max):	27 lbs (12.2 kg)

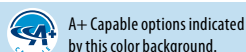
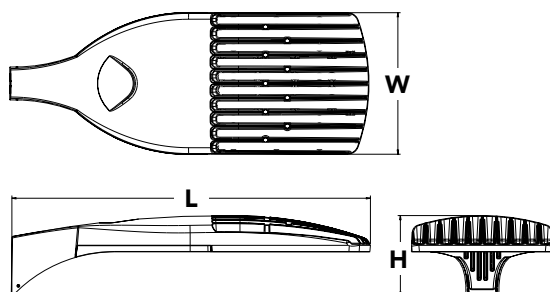

Catalog

Number

Notes

Type

Hit the Tab key or mouse over the page to see all interactive elements.

Capable Luminaire

This item is an A+ capable luminaire, which has been designed and tested to provide consistent color appearance and system-level interoperability.

- All configurations of this luminaire meet the Acuity Brands' specification for chromatic consistency
- This luminaire is A+ Certified when ordered with DTL® controls marked by a **shaded background**. DTL DLL equipped luminaires meet the A+ specification for luminaire to photocontrol interoperability¹
- This luminaire is part of an A+ Certified solution for ROAM® or XPoint™ Wireless control networks, providing out-of-the-box control compatibility with simple commissioning, when ordered with drivers and control options marked by a **shaded background**¹

To learn more about A+, visit www.acuitybrands.com/aplus.

1. See ordering tree for details.
2. A+ Certified Solutions for ROAM require the order of one ROAM node per luminaire. Sold Separately: [Link to Roam](#); [Link to DTL DLL](#)

Ordering Information

EXAMPLE: DSX1 LED P7 40K T3M MVOLT SPA DDBXD

DSX1LED						
Series	LEDs	Color temperature	Distribution	Voltage	Mounting	
DSX1 LED	Forward optics	30K 3000 K	T1S Type I short	T5S Type V short	MVOLT ^{4,5} 120 ⁶ 208 ^{5,6} 240 ^{5,6} 277 ⁶ 347 ^{5,6,7} 480 ^{5,6,7}	Shipped included
	P1 P4 P7	40K 4000 K	T2S Type II short	T5M Type V medium		SPA Square pole mounting
	P2 P5 P8	50K 5000 K	T2M Type II medium	T5W Type V wide		RPA Round pole mounting
	P3 P6 P9	AMBPC Amber phosphor converted ²	T3S Type III short	BLC Backlight control ^{2,3}		WBA Wall bracket
	Rotated optics		T3M Type III medium	LCCO Left corner cutoff ^{2,3}		SPUMBA Square pole universal mounting adaptor ⁸
	P10 ¹ P12 ¹		T4M Type IV medium	RCCO Right corner cutoff ^{2,3}		RPUMBA Round pole universal mounting adaptor ⁸
	P11 ¹ P13 ¹		TFTM Forward throw medium			Shipped separately
			T5VS Type V very short			KMA8 DDBXD U Mast arm mounting bracket adaptor (specify finish) ⁹
Control options				Other options	Finish (required)	
Shipped installed			PIRH1FC3V Bi-level, motion/ambient sensor, 15-30' mounting height, ambient sensor enabled at 1fc ^{5,15,16}	Shipped installed	DDBXD Dark bronze	
NLTAIR2	nLight AIR generation 2 enabled ¹⁰		BL30 Bi-level switched dimming, 30% ^{5,14,18}	HS House-side shield ²¹	DBLXD Black	
PER	NEMA twist-lock receptacle only (controls ordered separate) ¹¹		BL50 Bi-level switched dimming, 50% ^{5,14,18}	SF Single fuse (120, 277, 347V) ⁶	DNAXD Natural aluminum	
PER5	Five-wire receptacle only (controls ordered separate) ^{11,12}		PNMTDD3 Part night, dim till dawn ^{5,19}	DF Double fuse (208, 240, 480V) ⁶	DWHXD White	
PER7	Seven-wire receptacle only (controls ordered separate) ^{11,12}		PNMT5D3 Part night, dim 5 hrs ^{5,19}	L90 Left rotated optics ¹	DDBTXD Textured dark bronze	
DMG	0-10V dimming extend out back of honsing for external control (leads exit fixture)		PNMT6D3 Part night, dim 6 hrs ^{5,19}	R90 Right rotated optics ¹	DBLBXD Textured black	
DS	Dual switching ^{13,14}		PNMT7D3 Part night, dim 7 hrs ^{5,19}	Shipped separately	DNATXD Textured natural aluminum	
PIR	Bi-level, motion/ambient sensor, 8-15' mounting height, ambient sensor enabled at 5fc ^{5,15,16}		FAO Field adjustable output ²⁰	BS Bird spikes ²²	DWHGXD Textured white	
PIRH	Bi-level, motion/ambient sensor, 15-30' mounting height, ambient sensor enabled at 5fc ^{5,15,16}			EGS External glare shield ²²		
PIRHN	Network, Bi-Level motion/ambient sensor ¹⁷					
PIR1FC3V	Bi-level, motion/ambient sensor, 8-15' mounting height, ambient sensor enabled at 1fc ^{5,15,16}					



1. Remove the 6 (DSX2) or 4 (DSX0 and DSX1) screws shown from fixture (See Fig 1).

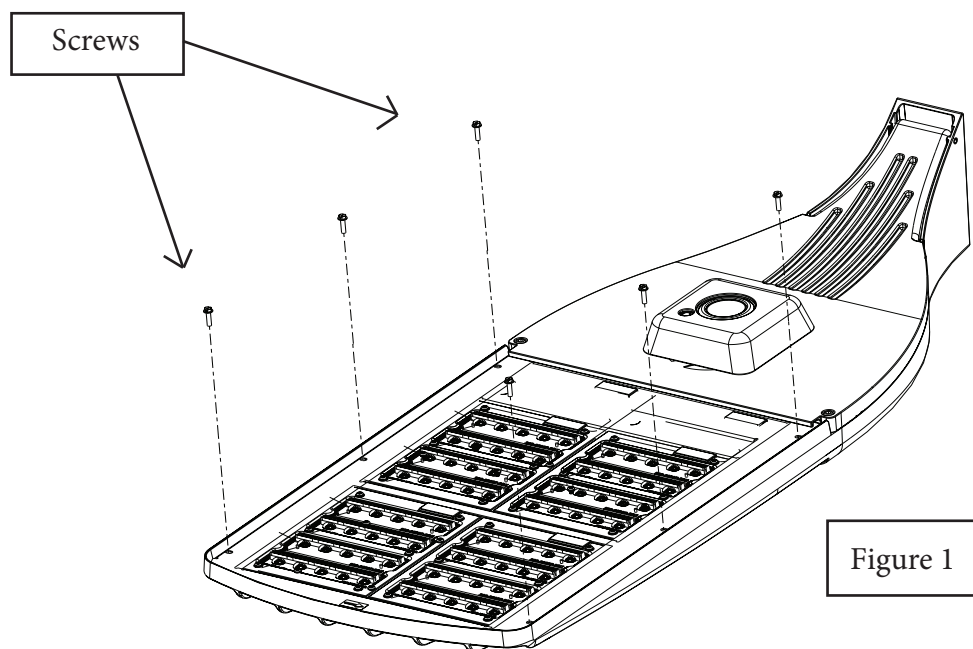

2. Place new EGS shield onto the fixture as shown and attach both the cover and EGS using the same screws that were removed in step one (See Fig 2). Please note that you will be using the four inner holes on the DSX0.

